



# XUPERMASK

XUPERFAB - USER MANUAL

## FACE COVER INSTRUCTIONS

### INSERTING FILTER INSERT INTO FACE COVER

Start with a fresh filter insert everyday. Remove filter insert prior to washing face cover.

Dispose of filter inserts properly after use.

1. Remove filter insert from wrapper.
2. Unfold filter insert by pinching both sides and gently pulling.
3. Locate Right (“R”) and Left (“L”) labels on the filter insert wings.
4. Slide each side under the band.

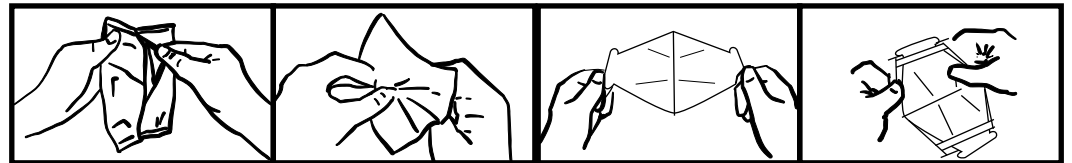

### HOW TO WEAR YOUR FACE COVER

Wash your hands before putting on the face cover.

Use hand sanitizer, if soap and water are not available.

1. To connect your earbud holders and neck strap to your face cover, pull rubber beads away from each other and fit each end of the earbud holder in between the beads and the ear loops. Then adjust to fit.
2. Cup the face cover in the hand allowing the ear loops and earbud holders to hang freely.
3. Pull the neck strap behind neck and earbud holders in front of neck.
4. Hold the face cover under the chin with the nosepiece facing upward.
5. Place one ear loop over the ear. Holding the face cover against the face with the other hand, place the second ear loop over the ear. Adjust fit of the ear loops by sliding the bead on each side; closer to ear to tighten and away from ear to loosen.

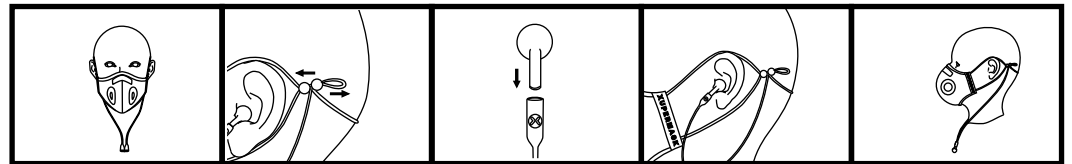

# XUPERMASK INSTRUCTIONS



6. Mold the nose area to the shape of the face by pinching the top nose piece.
7. Insert your earbuds by sliding the ends of your earbuds into the rubber holder.
8. Connect the two ends of the earbud holders in front of your chest by using the embedded magnets.

## HOW TO CHANGE YOUR PATCHES

1. Remove patch by pulling on the patch and separating the hook and loop.
2. Store your patches on the box panels.

## HOW TO REMOVE YOUR FACE COVER

Be careful not to touch your eyes, nose, or mouth when removing face cover or filter insert.  
Wash hands immediately after use.

1. Stretch the ear loops and lift over ear and pull neck strap over head.
2. Remove single use filter insert and dispose of properly. Do not wash the filter insert.
3. To safely discard the used filter insert, place it in a plastic bag and put it in the trash.

## HOW TO CLEAN YOUR FACE COVER

Remove filter insert and patches before cleaning.

Hand wash face cover with mild soap and warm water. Do not bleach. Do not tumble dry.

Do not dry clean. Do not iron. Hang or lay flat to dry.

